

3663 WIDE COMMON PASSAGE

4.5 M X 5 M GATE

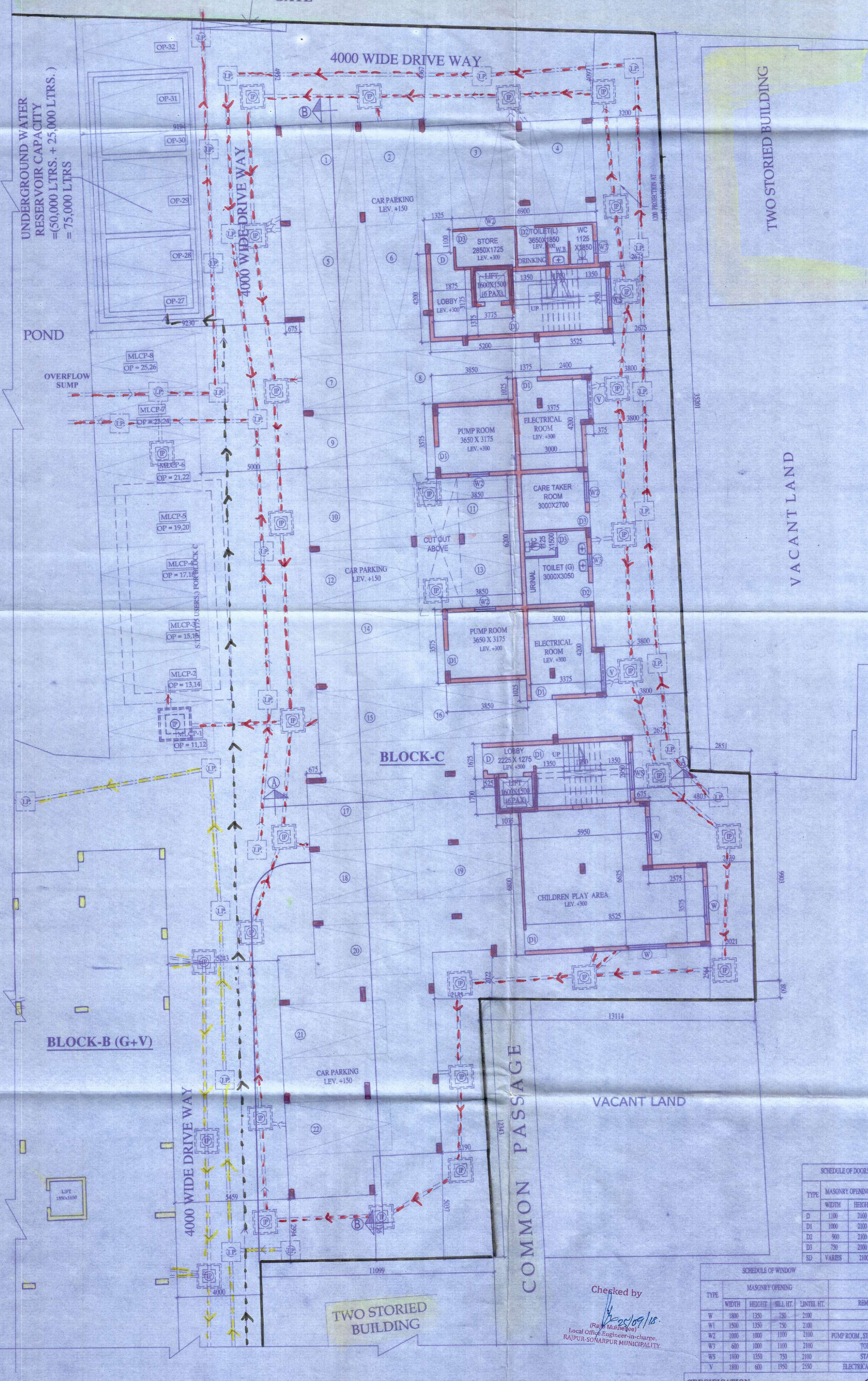

UNDERGROUND WATER RESERVOIR CAPACITY = (50,000 LTRS. + 25,000 LTRS.) = 75,000 LTRS.

POND

OVERFLOW SUMP

BLOCK-B (G+V)

BLOCK-C

COMMON PASSAGE

VACANT LAND

TWO STORED BUILDING

VACANT LAND

TWO STORED BUILDING

GROUND FLOOR PLAN

Checked by
Rajiv Mukherjee
Local Officer, Engineer-in-charge,
RAJPUR-SONARPUR MUNICIPALITY.

SCHEDULE OF DOORS

TYPE	MASONRY OPENING	REMARKS	
	WIDTH	HEIGHT	
D	1100	2100	
D1	1000	2100	
D2	900	2100	KITCHEN
D3	750	2100	TOILET
SD	VARIES	2100	VER.

SCHEDULE OF WINDOW

TYPE	MASONRY OPENING	REMARKS	
	WIDTH	HEIGHT	
W	1800	1350	2100
W1	1500	1350	2100
W2	1000	1000	2100
W3	600	1000	2100
W5	1800	1350	2100
Y	1800	600	1950

- SPECIFICATION**
1. ALL DIMENSIONS ARE IN M.M. UNLESS OTHERWISE SPECIFIED
 2. ALL OUTER WALLS ARE 230 M.M.
 3. ALL PARTITION WALLS ARE 100 M.M. UNLESS OTHERWISE SPECIFIED
 4. BRICK WORK OF ALL 230 WALLS SHALL BE IN CM 1:4:8
 5. BRICK WORK OF ALL 100 WALLS SHALL BE IN CM 1:4 WITH 1/8 NETTING
 6. 15 M.M. TH. C. PLASTER WITH C.M. (1:6) FOR OUTER WALLS
 7. 20 M.M. TH. C. PLASTER WITH C.M. (1:6) FOR INSIDE WALLS
 8. 13 M.M. TH. C. PLASTER WITH C.M. (1:6) FOR CEILING
 9. 25 M.M. TH. D.P.C. (1:24) SHALL BE PROVIDED
 10. 10 M.M. TH. VITRIOUS TILES FLOORING
 11. 150 M.M. WIDE VITRIOUS SKirting
 12. THE DEPTH OF SEWAGE TREATMENT PLANT & WATER RESERVOIR WOULD NOT EXCEED THE DEPTH OF MAIN BUILDING FOUNDATION
 13. GRADE OF CONCRETE (R.C.C.) M-25
 14. GRADE OF STEEL - Fe-600

STARLITE INFRACON PVT. LTD.
Director

Signature of Owners

DECLARATION OF E.B.A.
I HAVE CERTIFIED ON THE PLAN ITSELF WITH FULL RESPONSIBILITY THAT BUILDING RULES 2007 AS AMENDED FROM TIME TO TIME AND THAT THE SITE CONDITIONS INCLUDING THE ABUTTING ROAD CONFORM WITH THE PLAN AND THAT IT IS A BUILDABLE SITE AND NOT A TANK OR A FILLED UP LAND.

MUKUL MITTRA
B. ARCH (HONS) FIA. AIV
REGISTERED ARCHITECT
REG. NO. CA/75/003

SIGNATURE OF ARCHITECT
MUKUL MITTRA
B. ARCH (HONS), PILLAY
EMPANELMENT NO. 656/RJPS ON/EBA/2008-09

CERTIFICATE OF STRUCTURAL STABILITY
I HEREBY DECLARE THAT THE FOUNDATION AND SUPER-STRUCTURE OF THE BUILDING PROPOSED FOR CONSTRUCTION ON R.S. DAG NO-3102,3103,3139, LR 3140,3141,3220,3143,3142, RS 3106,3168 & 3105 KHATIAN NO- RS 666,684/2,468, LR 712,573,83,60, 1367,1642,11,1151 & 1648 J.L. NO-71, MOUZA - JAGADDAL, WARD NO-25, HOLDING NO-11 UNDER RAJPUR, SONARPUR MUNICIPALITY, HARINAVI, KOLKATA - 700 148 HAVE BEEN SO DESIGNED BY ME THAT IT WILL MAKE SUCH FOUNDATION AND SUPER-STRUCTURE SAFE IN ALL RESPECT INCLUDING THE CONSIDERATION OF BEARING CAPACITY OF SOIL ETC.

BIBEK BIKASH MULLICK
Rajpur Sonarpur Municipality
E.S.E. 021

SIGNATURE OF STRUCTURAL ENGINEER
BIBEK BIKASH MULLICK
B.E. (CIVIL)
EMPANELMENT NO. - ESE-021

K. Sengupta
KAUSHIK SENGUPTA
B.E. (CIVIL), M.E. (STRUCTURE)
EMPANELMENT NO. - ESE-035

SIGNATURE OF STRUCTURAL REVIEWER
KAUSHIK SENGUPTA
B.E. (CIVIL), M.E. (STRUCTURE)
EMPANELMENT NO. - ESE-039

ALOK ROY
Enlightened Geotechnical Engineer
Rajpur - Sonarpur Municipality
No. - 008/G.T. Eng.

SIGNATURE OF GEO-TECHNICAL ENGINEER
ALOK ROY
B.E. (CIVIL), M.C.E. (FOUNDATION ENGG.)
EMPANELMENT NO. - GT/008

PROJECT TITLE :
PROPOSED G+XII, G+V(2NOS), G+IV STORED RESIDENTIAL BUILDING AT R.S. DAG NO. - 3102, 3103, 3139, LR3140, 3141, 3220, 3143, 3142, RS 3106, 3168 & 3105 KHATIAN NO- RS 666,684/2,468, LR 712,573,83,60, 1367,1642,11,1151 & 1648 J.L. NO-71, MOUZA - JAGADDAL, WARD NO-25, HOLDING NO-11 UNDER RAJPUR, SONARPUR MUNICIPALITY, HARINAVI, KOLKATA - 700 148
PREV. SANC. NO. : 1297/CB/25/21 DATED - 13/01/2014
NAME OF OWNER = M/S STARLITE INFRACON PVT LTD & OTHERS

TITLE :
BLOCK - C (G+IV)

GROUND FLOOR PLAN

PROJECT ARCHITECT :-
CONSULTANTS FOR HUMAN SETTLEMENT
FLAT-38, THE Floor, 105 Park Street, Kolkata-700016
Tel.-91-33-22651363/64, E-mail : sengupta.shel@rediffmail.com
164/B Bechaman Chatterjee Street, Kolkata-700061 566 Anna Salui, Topsnet, Chennai-600018

DEALT BY: LAKSHMIPRIYA
SCALE : 1:100
DATE : 06.09.2018
DRG. NO. : DNP/ARCH/SUB/BLOCK - C/01

OFFICE USE ONLY
APPROVED
Plan No. 156/Rej/ps/25/44 dated 19/11/2018
Valid upto 19/11/2023

Assistant Engineer, Incharge P.W.D.
RAJPUR-SONARPUR MUNICIPALITY